

Fire Rating	Family and Type	Type Mark	Comments	Width
1 Hour	Basic Wall: SUPERIOR WALL	1	10' SUPERIOR FOUNDATION WALL WITH 2.5" CONT. RIGID INSULATION PLUS BATT INSULATION (R-19) BETWEEN SUPERIOR WALLS BUILT-IN 2X6 METAL STUD-TO PROVIDE A TOTAL R VALUE OF 31.5. SHOP DRAWINGS TO BE SUPPLIED TO ARCHITECT AND HABITAT FOR REVIEW BEFORE PROCEEDING WITH WORK. INTERIOR SIDE OF SUPERIOR WALL TO BE FINISHED WITH 5/8" TYPE 'X' FIRE RATED GYPSUM WALLBOARD	10"
1 Hour	Basic Wall: HABITAT EXT WALL	2	EXTERIOR BEARING WALL 2X6@16" c.c. WOOD STUDS WITH R-21 GREEN BATT INSULATION. PLUS 1" R-5 CONT. INSULATION TAPED AND SEALED. PROVIDE ONE LAYER OF EXTERIOR 5/8" TYPE 'X' FIRE RATED GYP. BD. ON EXTERIOR AND ONE LAYER OF 5/8" TYPE 'X' FIRE RATED GYPSUM BOARD ON INTERIOR	7"
1 hour	Basic Wall: habitat interior wall	3		7"
	Basic Wall: habitat interior wall	4		5"

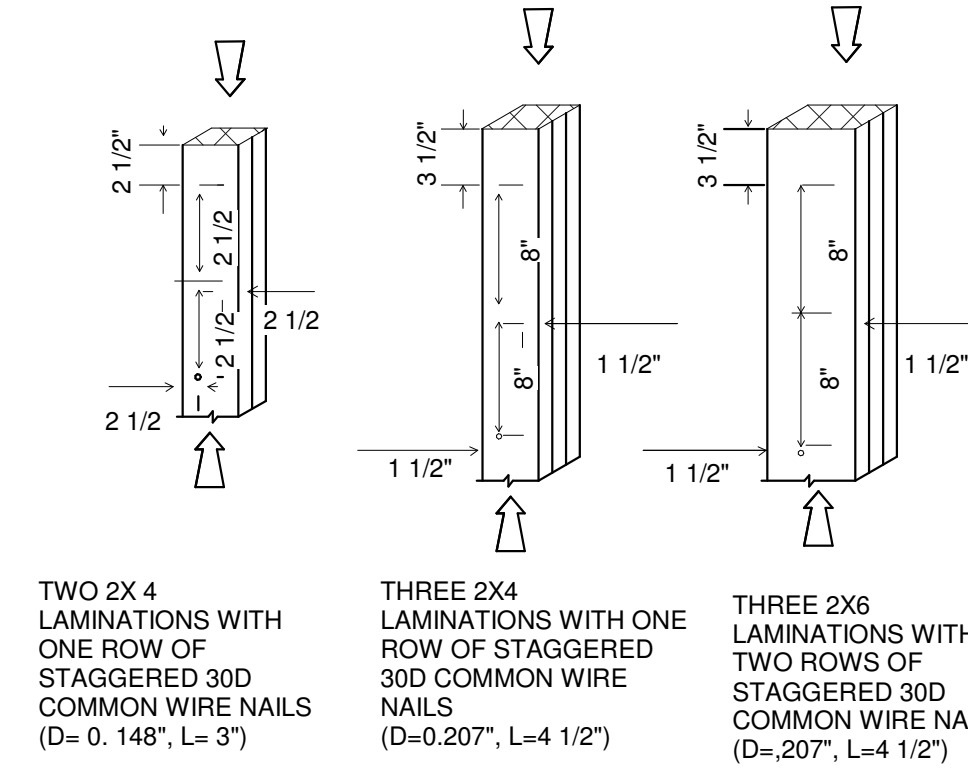

TYPICAL NAILING SCHEDULE FOR BUILT-UP COLUMNS

NOTES APPLICABLE FOR NAILED BUILD UP COLUMNS WITH 2 TO 5 LAMINATIONS:
 A) ADJACENT NAILS ARE DRIVEN FROM OPPOSITE SIDES OF THE COLUMN.
 B) ALL NAILS PENETRATE AT LEAST THREE QUARTERS OF THE THICKNESS OF THE LAST LAMINATION.
 C) 15 D < END DISTANCE < 18D.
 D) 20 D < SPACING BETWEEN ADJACENT NAILS IN A ROW < 6TMIN.
 E) 10 D < SPACING BETWEEN ROWS OF NAILS < 20 D.
 F) 50 < END DISTANCE < 20 D.
 G) 2 OR MORE LONGITUDINAL ROWS OF NAILS ARE PROVIDED WHEN D > 3TMIN.
 H) EACH LAMINATION HAS A RECTANGLE CROSS-SECTION AND IS AT LEAST 1 - 1/2" THICK.
 I) ALL LAMINATIONS HAVE THE SAME DEPTH (FACE WIDTH).
 J) FACES OF LAMINATIONS ARE IN CONTACT.
 K) ALL LAMINATIONS ARE FULL COLUMN LENGTH.
 L) K = 0.6 NAILED BUILT UP COLUMNS, C = 0.8 FOR SAWN LUMBER.
 M) WHEN ONLY ONE LONGITUDINAL ROW OF NAILS IS REQUIRED, ADJACENT NAILS SHALL BE STAGGERED. WHEN THREE OR MORE LONGITUDINAL ROWS AND NAILS ARE USED, NAILS IN ADJACENT ROWS SHALL BE STAGGERED.

WHERE:
 D = NAIL DIAMETER
 D = DEPTH (FACE WIDTH) OF INDIVIDUAL LAMINATION.
 TMIN = THICKNESS OF FINISHED LAMINATIONS > 1 1/2"

TYPICAL NAILING SCHEDULE FOR BUILT-UP COLUMNS

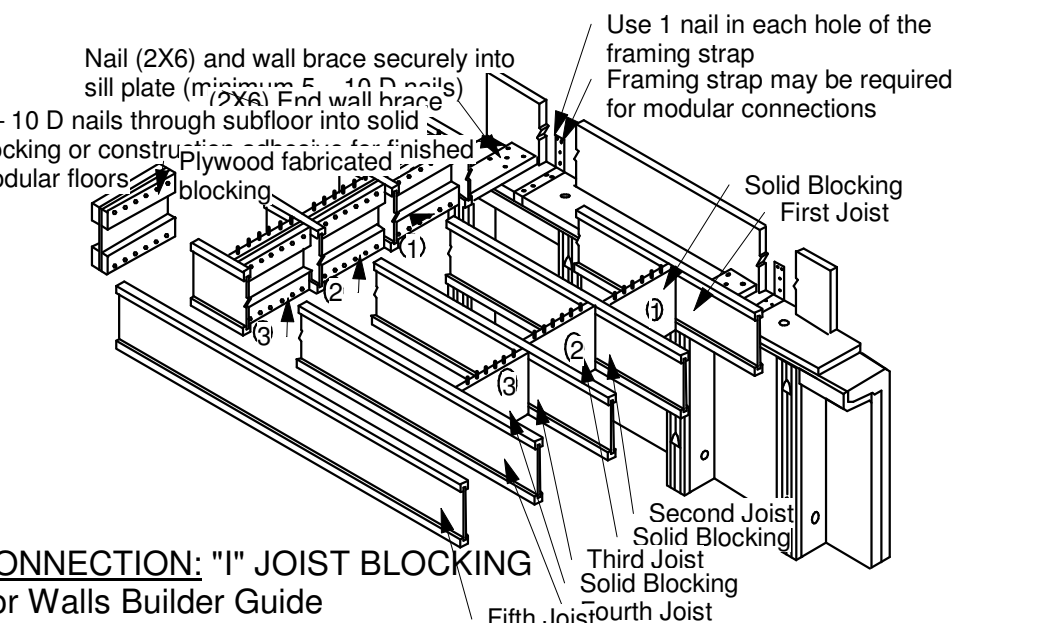
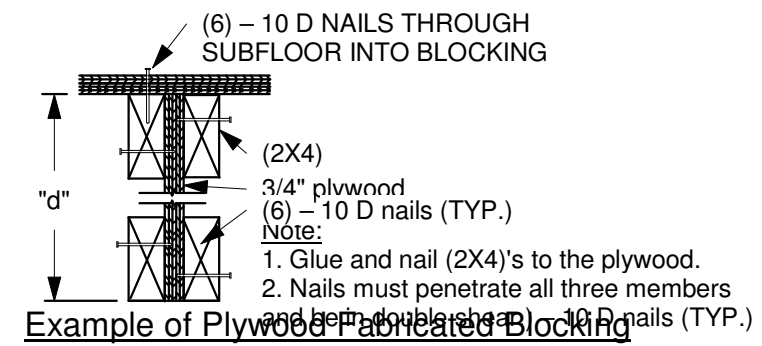
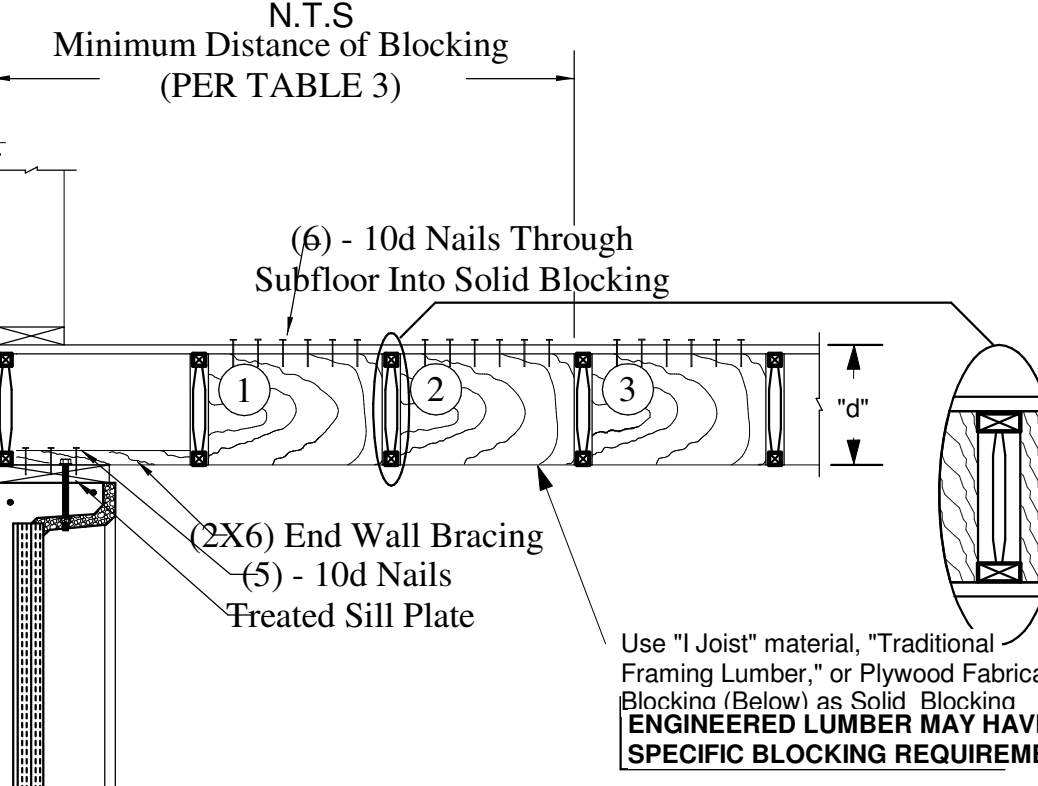

FIRST FLOOR PLAN
1/4" = 1'-0"

WINDOW SCHEDULE

WINDOW ID	# UNITS	MANUF.	CAT. NUMBER	WINDOW RO SIZE
A	5	MI	1650 DH	38.5X62.5 SEE NOTE BELOW**
B	4	MI	1650 DH	26.5X36.5
C	2	MI	1650-2 DH	76.5X62.5 SEE NOTE BELOW**

WINDOWS MARKED "A" TO MEET MIN. CLEAR OPENING OF 5.7 SQUARE FEET WITH A MIN. OPENING CLEAR HEIGHT OF 24" AND MIN. CLEAR OPENING WIDTH OF 20" AND SHALL BE OPERATIONAL FROM THE INSIDE OF THE ROOM WITHOUT USE OF KEY, TOOLS, OR SPECIAL KNOWLEDGE. THE WINDOWS SHALL HAVE A SILL HEIGHT OF NOT LESS THAN 24" AND NOT MORE THAN 44"

SECOND FLOOR PLAN
1/4" = 1'-0"

DOOR SCHEDULE

DOOR ID	NUMBER UNITS	DOOR SIZE	NOTES
EXTERIOR			
1	3	36W X 80	FRONT AND REAR ENTRY DOORS
2	1	96W X 84	O.H. GARAGE DOOR
INTERIOR			
3	1	36W X 80	FIRE RATED/INSULATED ENTRY/STORAGE/MECH DOORS
4	1	36W X 80	INSULATED ENTRY DOOR AT STAIR
5	1	2-23W X 80	BIFOLD DOORS-BIRCH LOUVERED IF REQUIRED BY LAUNDRY EQUIP.
8	8	34W X 80	BEDROOM/BATHROOM DOORS-BIRCH
8	4	2-24W X 80	SLIDING CLOSET DOORS-BIRCH

THIRD FLOOR PLAN
1/4" = 1'-0"

PROJECT: HABITAT RESIDENCE
NAME: 45 AUBURN STREET
ADDRESS: PATERSON, NEW JERSEY
CITY:

CLIENT: HABITAT FOR HUMANITY
NAME: 148 NORTH FIRST STREET
ADDRESS: PATERSON, NEW JERSEY
CITY:

CATHY F. BENSON, AIA.
 1156 EAST RIDGWOOD AVE.
 RIDGWOOD, NJ 0742

201.689.0742 | rkhasalati@aol.com
 NJ 21A100906300 | NY 016849-1
 NCARP 31, 758

ISSUE DATE: 05/20/19
 SCALE: As indicated
 DRAWN BY: Author
 JOB NO.: 22-P107
 TITLE: FLOOR PLANS
 SHEET NO.: A-2 OF 6